



MAINSTAGE VENUE SPECS

LIGHTING (ArtPoint Gallery, Alexandra Centre, Festival Hall, Lantern Church Hall):

6 ETC Source 4 Jr. & 6 ETC Parnels

Six lighting areas --- DSL / DSC / DSR / USL / USC / USR

→→ Each lit area has its own channel

Two instrument warm wash / two instrument cool wash

→→ Each instrument on their own channel

Two specials – gobo capable (M-size, metal only. Fringe Artist to provide. One gobo per show.)

→→ If you require a specific special gel colour, you will be required to provide it

All lighting will be at 45-degree sides, no top or back lighting

→→ ETC SmartFade Console SF 12 / 24 – programmable lighting board

LIGHTING (Lantern Church Sanctuary):

8 par cans, gauged 2 per channel; 4 ETC Source4 Four Jrs

Six lighting areas J DSL / DSC / DSR / USL / USC / USR

→→ Each lit area has its own channel

Two instrument warm wash / two instrument cool wash

→→ Each instrument on their own channel

Two specials – gobo capable (M-size, metal only. Fringe Artist to provide. One gobo per show.)

→→ If you require a specific special gel colour, you will be required to provide it

All lighting will be at 45-degree sides, no top or back lighting

→→ NSI-MC7008 8 channel 2 scene preset

SOUND (ArtPoint Gallery, Alexandra Centre, Festival Hall, Lantern Church Hall, Lantern Church Sanctuary):

Minimum 8 channel sound mixer, 2 PA powered speakers

1 microphone w/ XLR

→→ You will be required to bring any connection chords going in or out of the mixer for laptops, IPODs or MP3 players.

STAGE:

Stage Surfaces:

Lantern Church Hall – Wood flooring
Lantern Church Sanctuary – Hardwood
Festival Hall - Staging Risers
ArtPoint Gallery - Lacquered Cement
Alexandra Centre - Laminated Floor

SEATING CAPACITY:

There is raked seating at all the venues *except* Festival Hall and the Lantern Church venues which have raised stages.
(seating number subject to change)

Lantern Church Basement - 85
Lantern Church Sanctuary - 185
Festival Hall - 90
ArtPoint Gallery - 70
Alexandra Centre - 116

TECHNICIAN:

One venue tech for each Indoor Theatre venue, with the possibility of a Junior Tech assisting. If you have a lot of light and sound cues, your stage manager may have to run either lighting or sound. Please use your tech time wisely!

STORAGE SPACE:

Storage space is very limited.

Artists are required to supply anything extra they wish to use that is not provided here. No smoke, open fires or cigarettes can be used during shows.

Alexandra Centre
 922 – 9 Ave SE

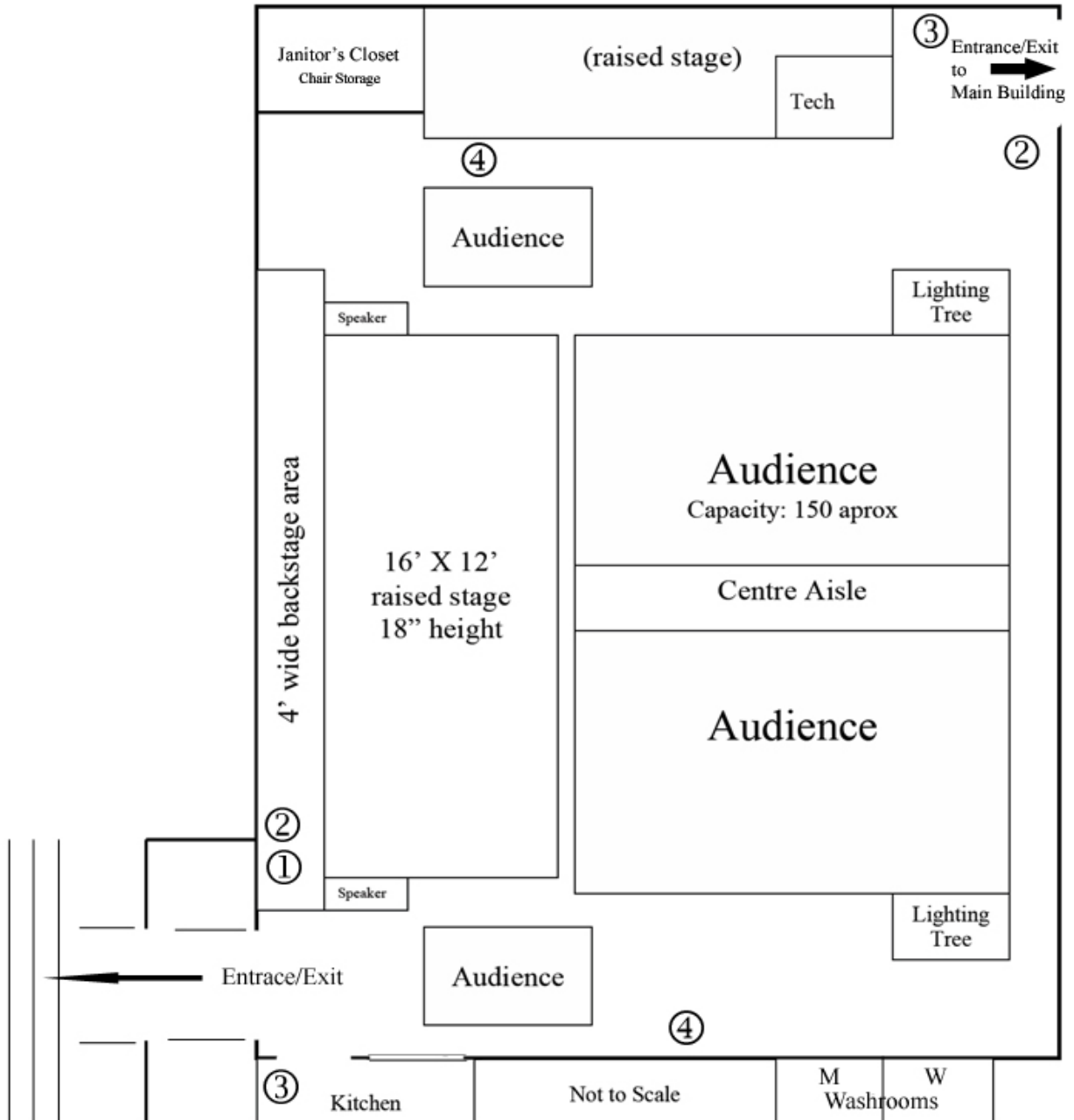

KEY: ① Light Switch ② Fire Alarm ③ Fire Extinguisher ④ Plug In

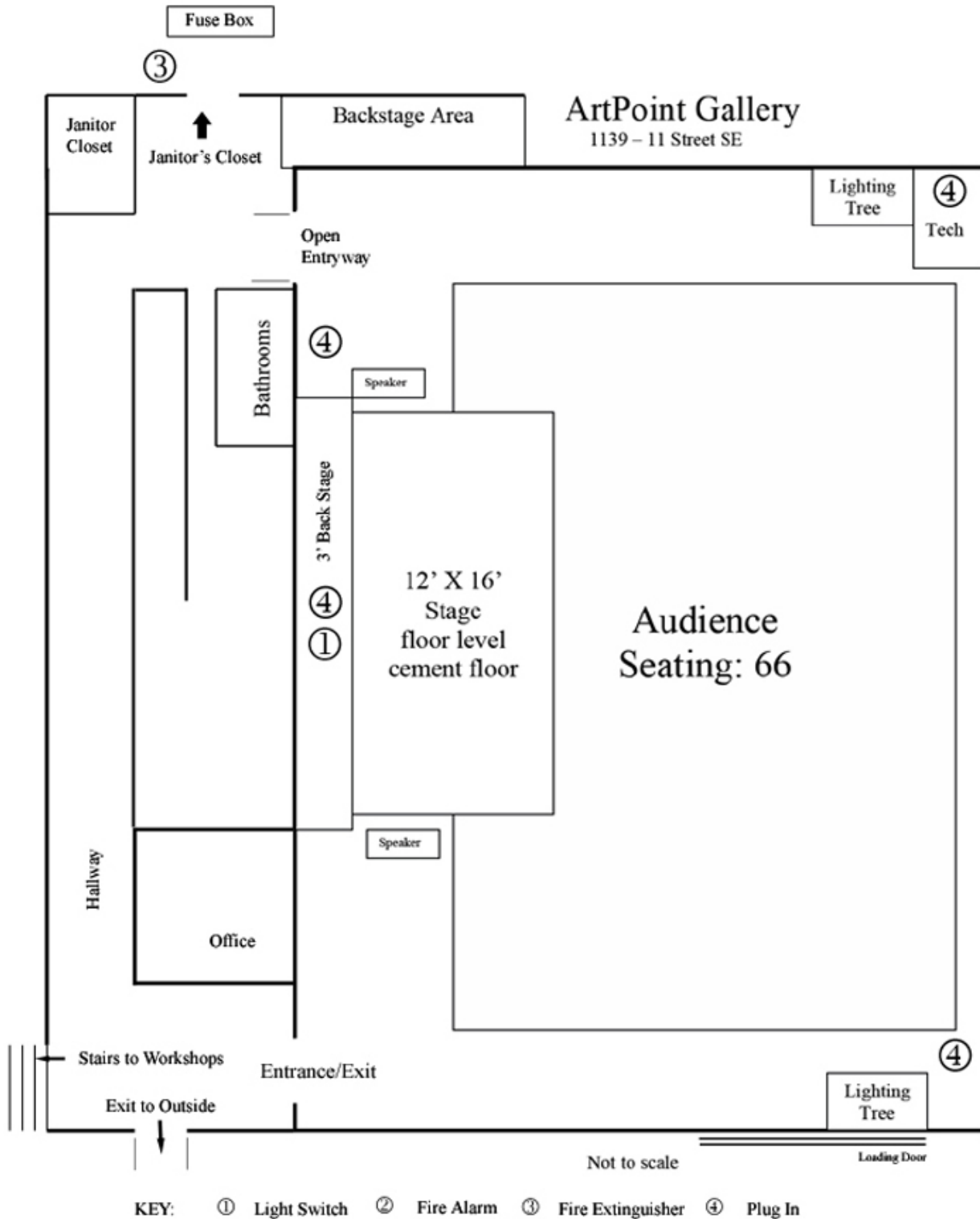

Venue Plan ↓

