

Calgary Fringe Venue Specifications

LIGHTING:

6 ETC Source 4 Jr. & 6 ETC Parnels

Six lighting areas - DSL / DSC / DSR / USL / USC / USR

→ Each lit area has its own channel

Two instrument warm wash / two instrument cool wash

→ Each instrument on their own channel

Two specials – gobo capable (M-size, metal only. Fringe Artist to provide. One gobo per show.)

→ If you require a specific special gel colour, you will be required to provide it

All lighting will be at 45-degree sides, no top or back lighting

→ ETC SmartFade Console SF 12 / 24 – programmable lighting board

SOUND:

- Minimum 8 channel sound mixer, 2 PA powered speakers

- 1 CD player, 1 microphone w/ XLR

→ You will be required to bring any connection chords going in or out of the mixer for laptops, IPODs or MP3 players

STAGE:

Stage Surfaces:

Church Gym - hard wood

Venu 1008 - staging risers

ArtPoint - lacquered cement

Alexandra - laminated floor

SEATING CAPACITY:

There is raked seating at all the venues except Venu 1008, which has a raised stage.

(seating number subject to change)

Church Gym - 76

Venu 1008 - 85

ArtPoint - 60

Alexandra - 150

TECHNICIAN:

One venue tech for each Indoor Theatre venue -if you have a lot of light and sound cues, your stage manager may have to run either lighting or sound. Please use your tech time wisely.

STORAGE SPACE:

Storage space is very limited.

Artists are required to supply anything extra they wish to use that is not provided here. No smoke, open fires or cigarettes can be used during shows.

Lantern Church - Gym

1401 - 10 Ave SE

- KEY:**
- ① Light Switch
 - ② Fire Alarm
 - ③ Fire Extinguisher
 - ④ Plug In

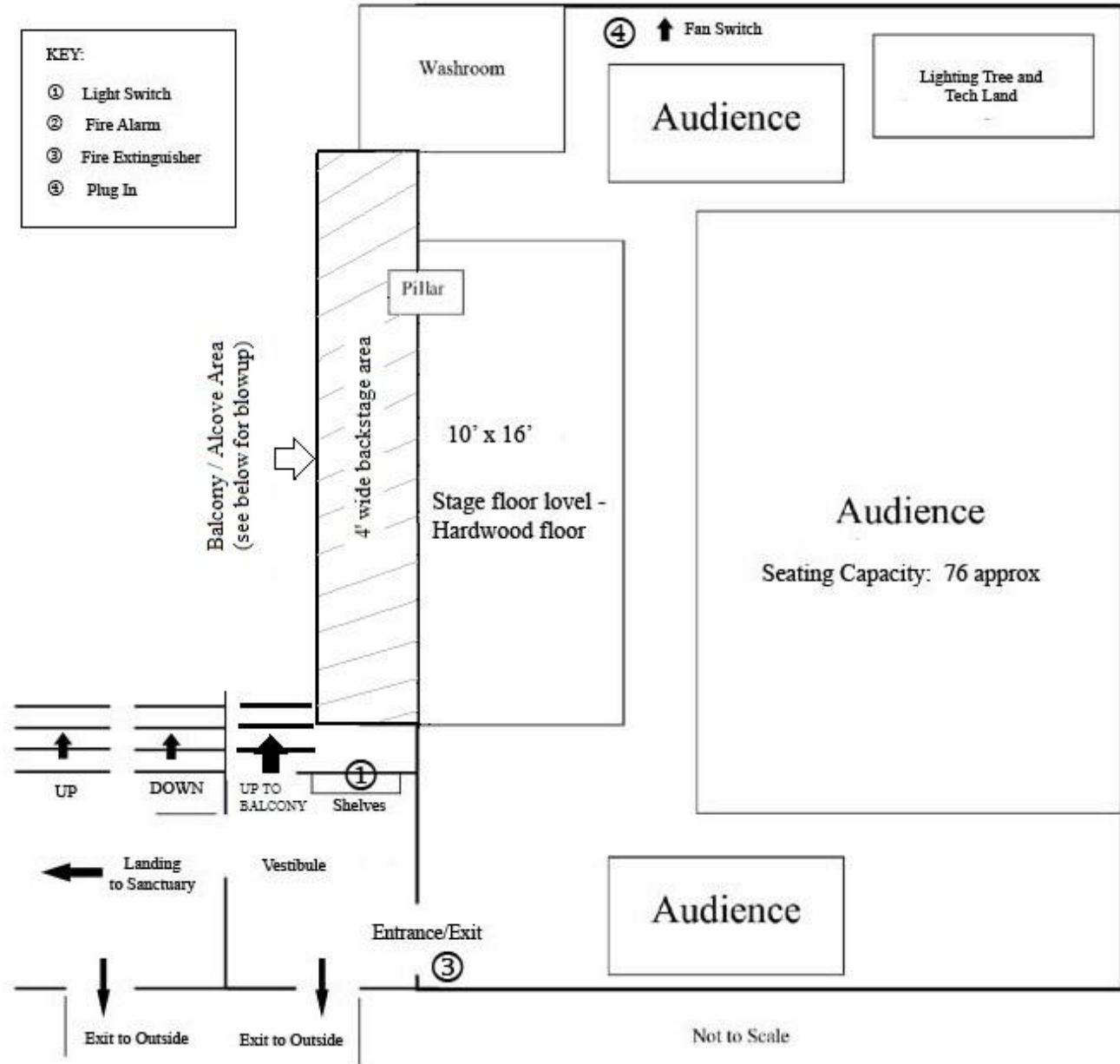

Blow up of Alcove / Balcony →

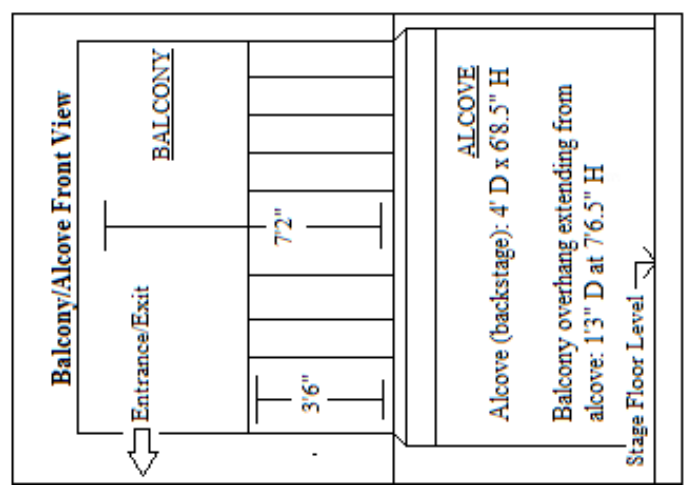

VENU 1008 – Big Room

1008 – 14th Street SE

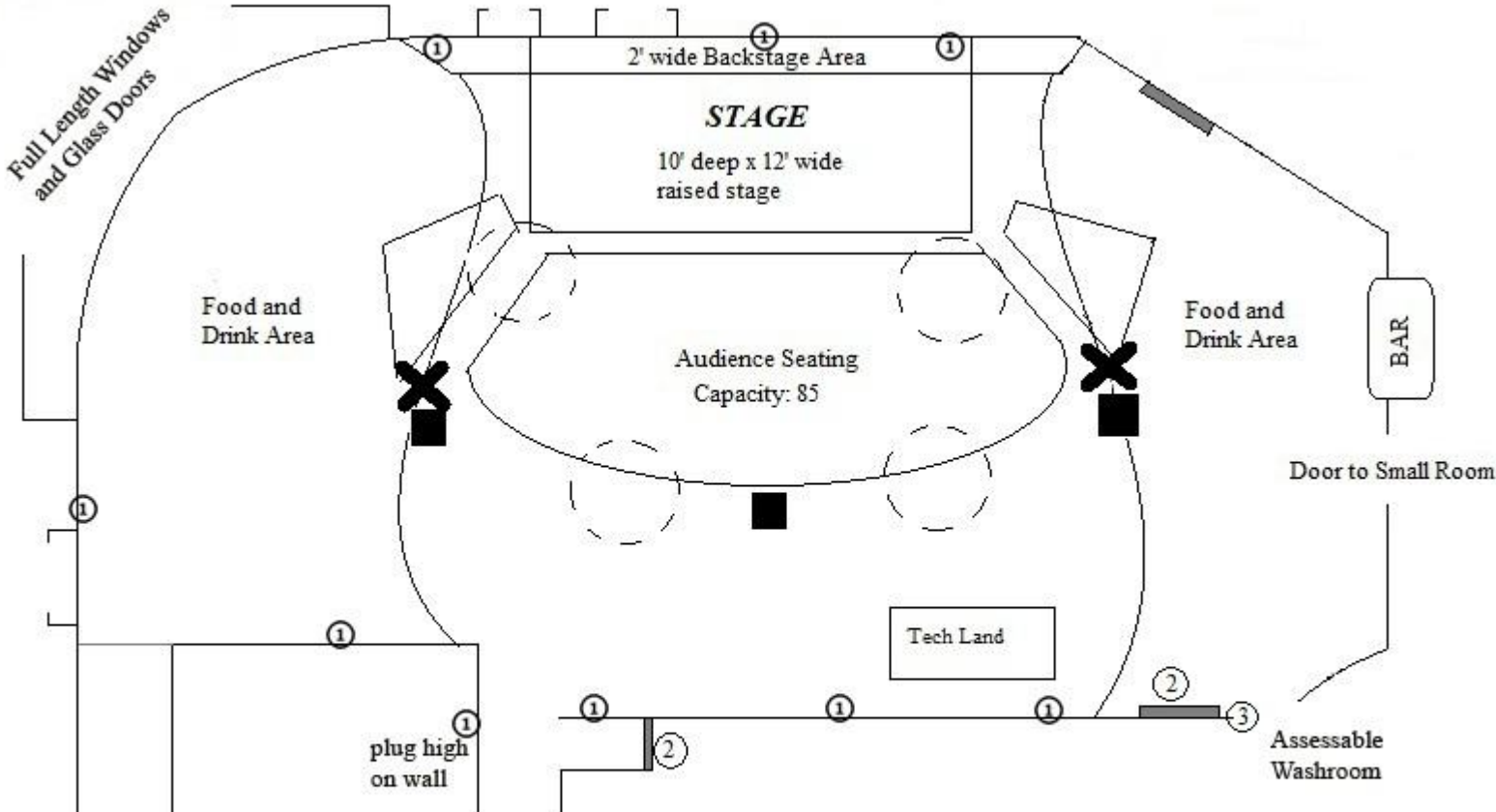

To Bathrooms **Key:**

- ① Electrical Plug-Ins
- ② Doors to Kitchen
- ③ 220 Circuit
- ④ Fire Extinguisher
- Pillar
- ⌈ ⌋ Window
- Lowered Ceiling Lamps
- ✕ Lighting Trees

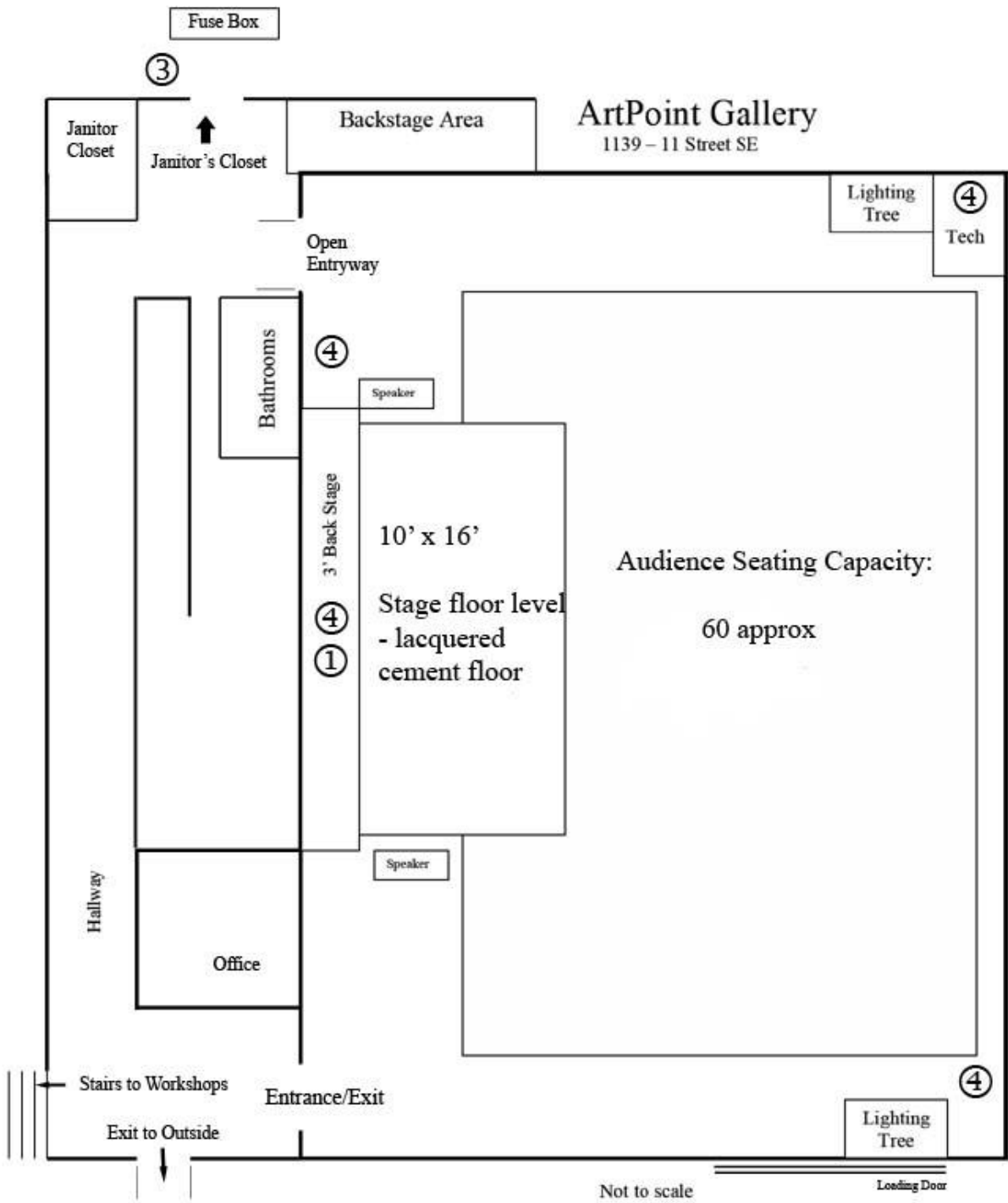

KEY: ① Light Switch ② Fire Alarm ③ Fire Extinguisher ④ Plug In

Alexandra Centre

922 - 9 Ave SE

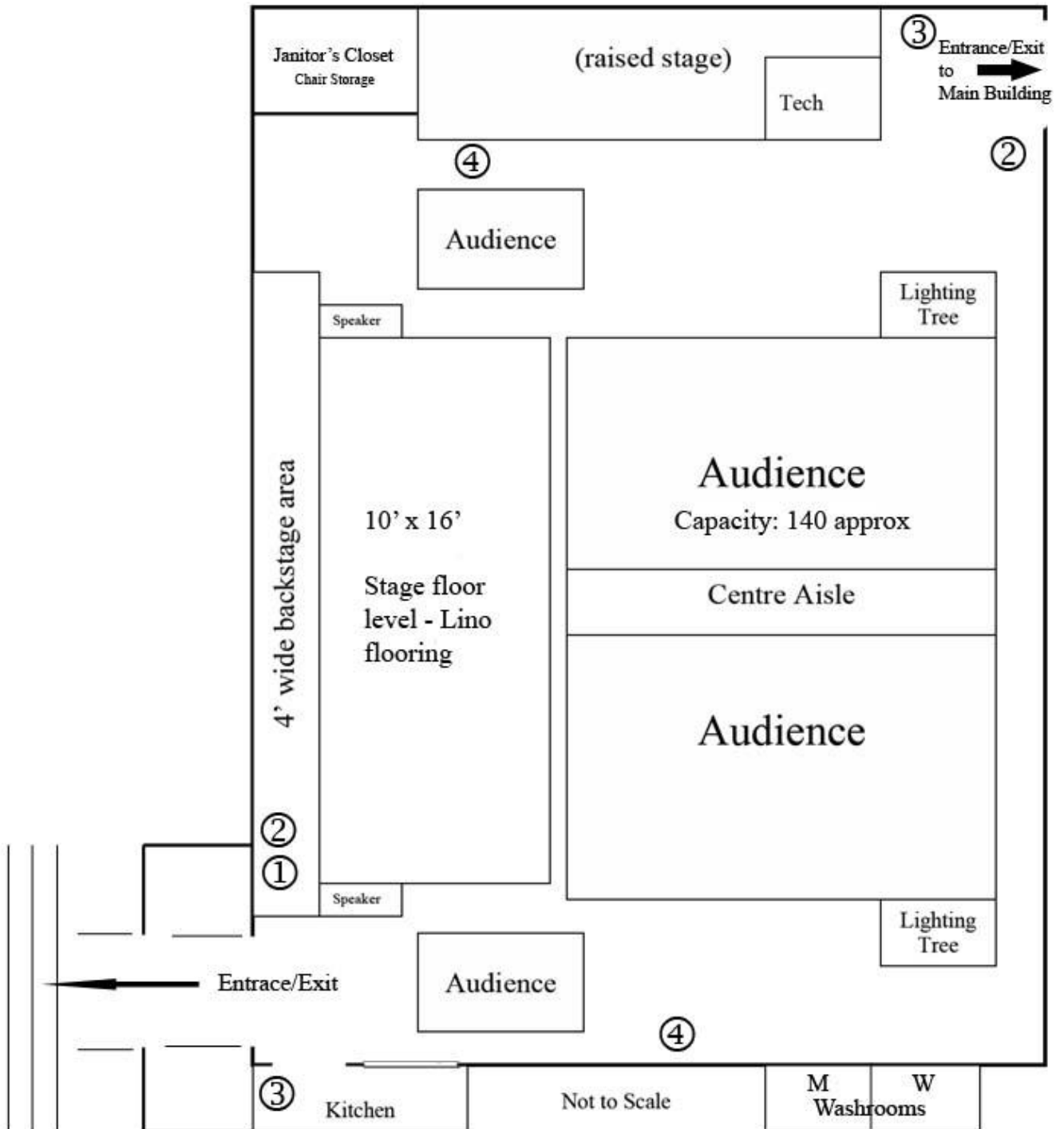

KEY: ① Light Switch ② Fire Alarm ③ Fire Extinguisher ④ Plug In